

# sprocket & chain kit

The **Sprocket and Chain kit** is designed to interface with the Motion Subsystem of the Vex Inventor's Kit. With these components, you can create a new drive system for your robot that only uses one motor, add a gripper arm with a movable claw, build an extendable ladder for a fire-fighting robot, and more!

**INSERT THIS PAGE**  
at the **back of the**  
**Motion chapter** in your  
Vex Inventor's Guide.

chain links (preassembled) x 326



sprocket (10 teeth) x 2

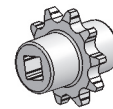

sprocket (15 teeth) x 4

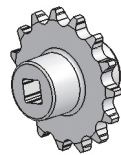

sprocket (24 teeth) x 4

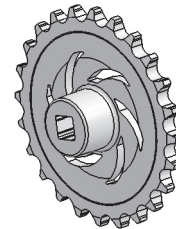

sprocket (40 teeth) x 2

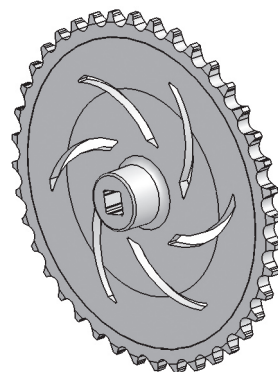

sprocket (48 teeth) x 2

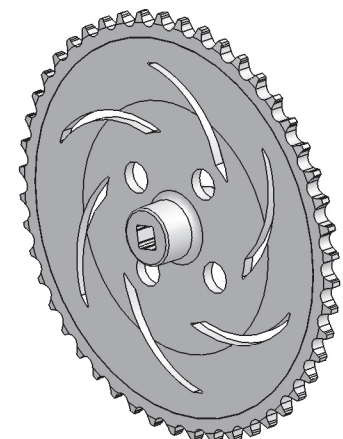

### sprocket & chain kit, continued

#### Chain Drives

Chain drives are an accurate, reliable form of actuation. Because a chain doesn't slip or stretch as easily as a belt does, it can maintain a constant speed under a variety of different loads, and should require only minimal maintenance.

A chain drive is also an extremely efficient system, transferring up to 95% of the power from the drive shaft. In comparison, a gear drive only transfers 85% of the power from the drive shaft, at best. A chain drive also allows you to transfer power from the drive shaft over a longer distance than would be possible or feasible solely with gears. This is particularly advantageous when the space through which you're trying to transfer that mechanical power is small or convoluted.

Chain drives are used in bicycles, conveyor belts, lawnmowers, cars, and a wide variety of other applications. If your robot needs to move a heavy load smoothly, or if it needs accurate position information, then a chain drive just might be the way to go.

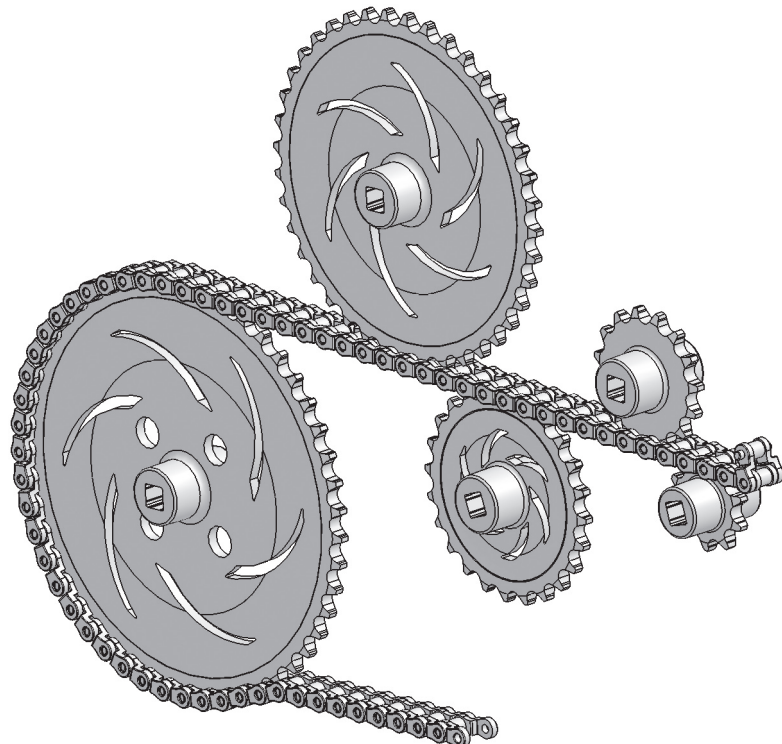

#### Limited 90-day Warranty

This product is warranted by Innovation One against manufacturing defects in material and workmanship under normal use for ninety (90) days from the date of purchase from authorized Innovation One dealers. For complete warranty details and exclusions, check with your dealer.

Innovation One, Inc.  
350 North Henderson Street  
Fort Worth, TX 76102

08/05

Printed in China

0405